



## Freddie S

18m MCA CAT 2

Wind Farm Support Vessel

### GENERAL

BUILDER	Southboats
DESIGN	Vigilante 18m
YEAR OF BUILD	Dec-2012
MCA	MCA Cat 2
CAPACITY	3 Crew + 12 Pax
FLAG	UK

# Delivering Offshore Support

Safe | Reliable | Versatile

[www.windwaveworkboats.co.uk](http://www.windwaveworkboats.co.uk)

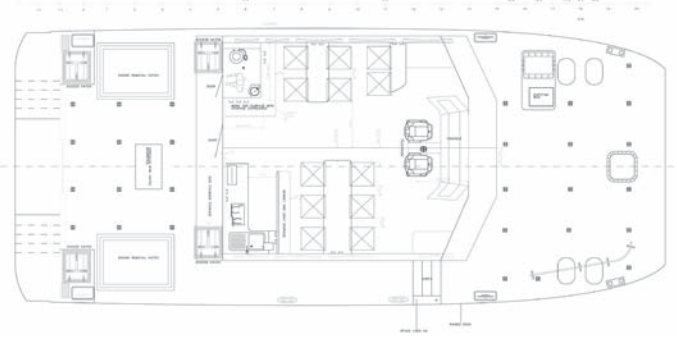
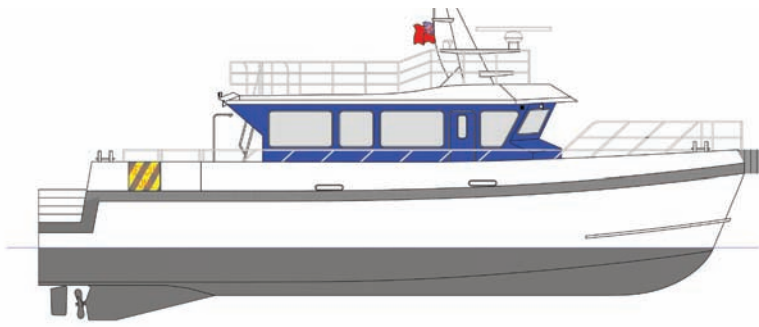

## Freddie S

18m MCA CAT 2 Wind Farm Support Vessel

### PERFORMANCE

MAX SPEED	24 knots
SERVICE SPEED	22 knots

### DIMENSIONS AND CAPACITIES

LENGTH O.A.	17.8 m
BEAM O.A.	7.4 m
DRAUGHT	1.6 m
CARGO DECK AREA FWD	27 m <sup>2</sup>
CARGO DECK AREA AFT	29 m <sup>2</sup>
CARGO LOAD FWD	2.5 tons
CARGO LOAD AFT	2.5 tons
MAX DECK LOAD	1.5 t/m <sup>2</sup>
FUEL OIL	8 m <sup>3</sup>
FRESH WATER	0.75 m <sup>3</sup>
BLACK WATER	0.25 m <sup>3</sup>

### DECK LAYOUT

CRANE	Bonfiglioni, 550kg@6.35m
MOUNTS	Multiple 5-Ton Lashing Points
FUEL TRANSFER	1800 l/h 65m
PRESSURE WASHER	41 l/min @200bar
FENDERING	Rubber D with Nipple

### WELFARE

SEATS	KAB 500
DECK HOUSE	12 seats, wet gear room, galley and heads
CABINS	Cabins for 4
HEATING	Eberspacher
ENTERTAINMENT	LCD TV, DVD, Radio, Internet

### SAFETY EQUIPMENT

SART	Tron SART 30
EPIRB	Tron 406 MHz
LIFE RAFTS	2 x 8 persons
MOB	Waterlevel Platforms
SAR FINDER	Sea Marshall
HANDHELD VHF	2 x Tron TR20
SEARCHLIGHT	Jabsco 255SL
ENGINE ROOM FIRE SYSTEM	Firepro Stat-X

### MAIN ENGINES

MAKE	MTU
TYPE	2 x 8V 2000 M72
MAX POWER	1930 bhp (1440kw)

### GEARBOXES

MAKE	Twin Disc
MODEL	2 x MGX5147R

### PROPULSION

TYPE	Fixed Pitch Prop
------	------------------

### GENERATOR

ELECTRICAL SYSTEM	24v, 230v shore and generator
MAKE	Cummins Onan
TYPE	MDKBJ (Spec A)
OUTPUT	7.5kw

### ELECTRONICS

MAIN RADAR	Furuno 4ft FR8062
SECOND RADAR	Furuno DRS24D 24" Radome
ECDIS	2 x Furuno Navnet 3d
NAVTEX	Furuno NX300
GPS	Furuno GPS
SATELLITE COMPASS	Furuno SC50
ANEMOMETER	Maretron W50100
ECHO SOUNDER	Furuno FLV/585
AUTO PILOT	Furuno Nav Pilot 700
AIS	Furuno FA/150
VHF	3 x IC-M505
HAILER	Furuno LH300
CCTV	ENE0 System
BROADBAND	Globesurfer 3G